

JOB # 14-003

MAP 3

(Maps 1 and 2 not issued in this report)

Monitoring Points resurveyed 11/18/14

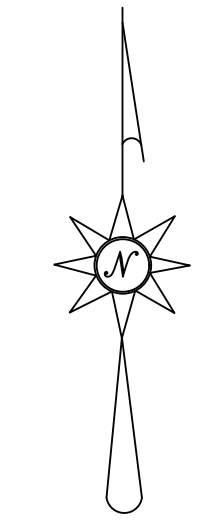

Approximate



VERIFY SCALE: If this scale does not measure 1 inch, then it has been altered through reproduction.

KEY TO SYMBOLS

- MP1 0.025H -0.05
- MP_a
- STA 1
- SI-1
- TM1
-
-
-
-
- A-A'
-
-

Not all landscaping areas shown

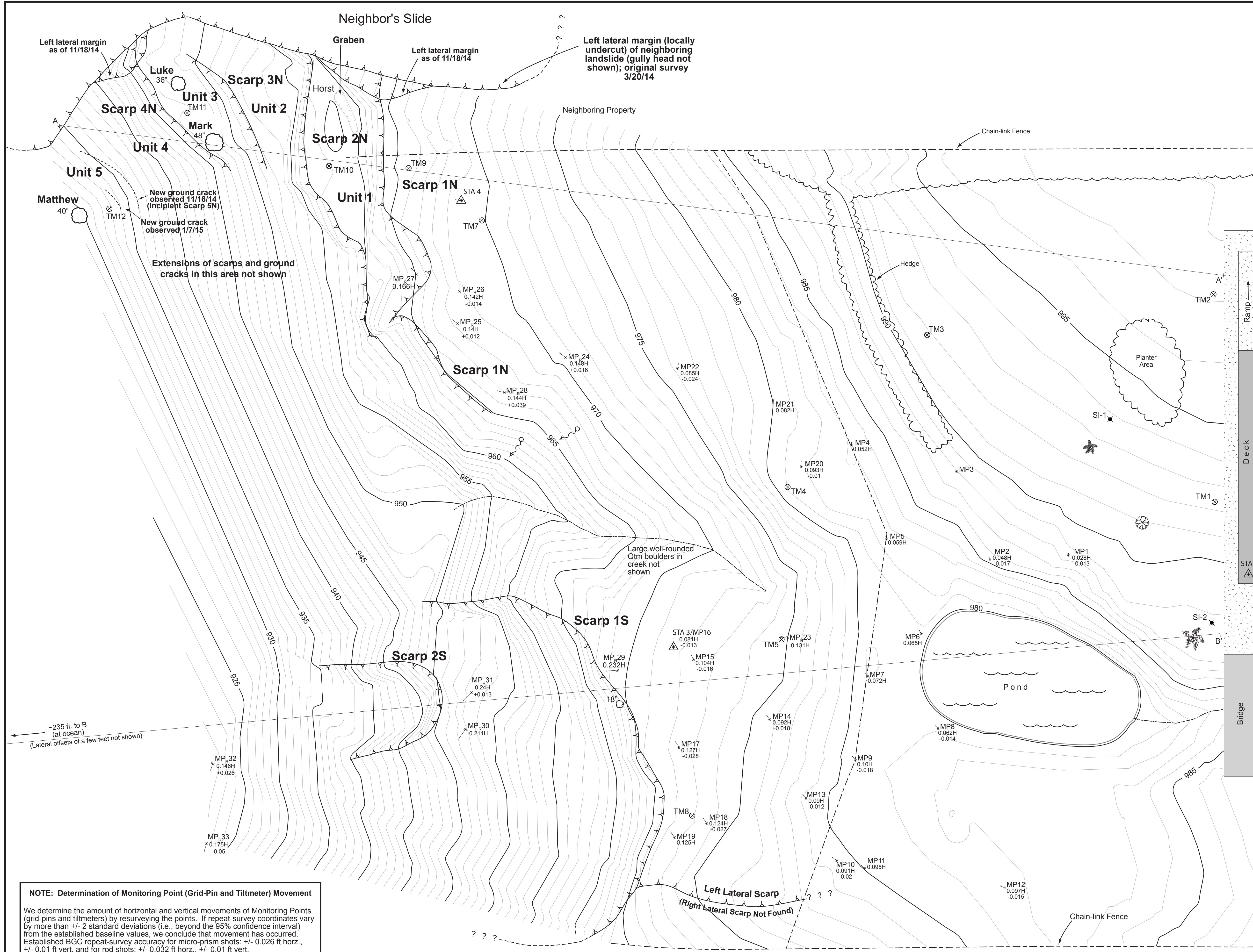

NOTE: Determination of Monitoring Point (Grid-Pin and Tiltmeter) Movement

We determine the amount of horizontal and vertical movements of Monitoring Points (grid-pins and tiltmeters) by resurveying the points. If repeat-survey coordinates vary by more than +/- 2 standard deviations (i.e., beyond the 95% confidence interval) from the established baseline values, we conclude that movement has occurred. Established BGC repeat-survey accuracy for micro-prism shots: +/- 0.026 ft horz., +/- 0.01 ft vert. and for rod shots: +/- 0.032 ft horz., +/- 0.01 ft vert.

SCALE: 1 inch = 10 feet
CONTOUR INTERVAL = 1.0 foot
 PRODUCTION DATE: 8 January 2015
 ORIGINAL SURVEY BY: REB and DJC 3/13/14 - 4/09/14 DRAFTED BY: DJC on 12/2/14 - 12/29/14

NOTES:

1. ELEVATION DATUM IS ARBITRARY.
2. THIS MAP WAS PRODUCED BY GEOLOGISTS WORKING UNDER THE DIRECTION OF A CERTIFIED ENGINEERING GEOLOGIST.
3. MAP NORTH FROM MAGNETIC NORTH WITH A DECLINATION OF -14.9 DEGREES EAST.

BUSCH GEOTECHNICAL CONSULTANTS

97832 S. Bank Chetco River Road, Brookings, OR 97415 (541) 469-7300 FAX (541) 469-2903

Geotechnical and Geological Studies for Land Development and Resource Management

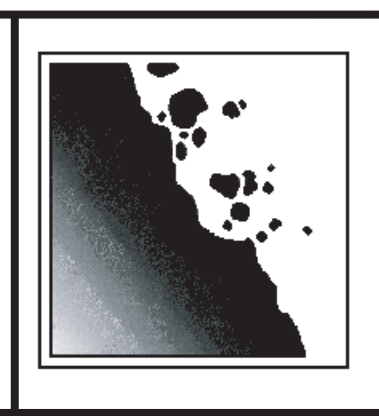

Mrs. Mary O'Reilly
Monitoring Point Map

3110 Patricks Point Drive Trinidad, California